

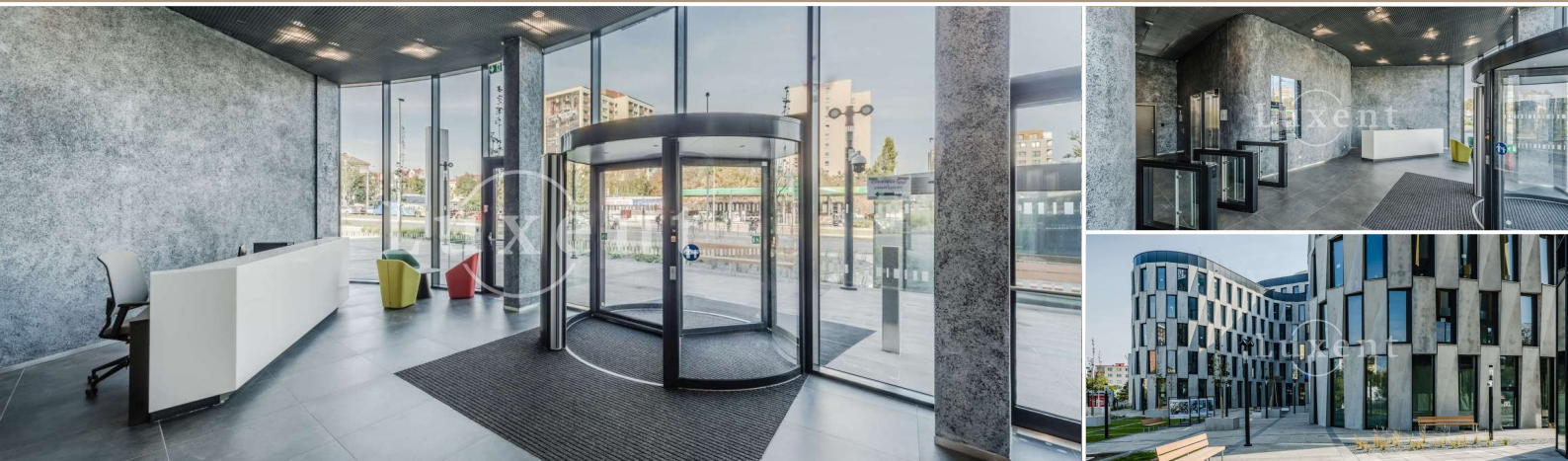

An office space for rent, 182 sqm, Evropská - Prague 6



🏠 182 m² 📄 Evropská 📅 379 CZK per m2 / month



WITH THIS PROPERTY, YOU'LL BE ASSISTED BY

Filip Sloupenský

COMMERCIAL LEASE SPECIALIST

filip.sloupensky@luxent.cz

+420 771 229 229

Order number	N6993	Price	379 CZK per m2 / month + services
Address	Evropská	Type	Offices
Usable area	182 m²	Parking	Yes
Low energy	No	Energy performance of the building	G - Extremely uneconomical
Floor	ground floor	Device	Partly
Lift	Yes	Date to move in	7. 8. 2024

About real estate

We offer for rent office space of 182 sqm in a modern administrative complex in Prague 6 - Dejvice. The complex was designed by the renowned architectural studio DAM architects. It consists of two buildings with six and eight floors, offering almost 14 thousand sqm of leasable area. The space can be variably adapted to tenants' requirements. In addition to office space, there are also retail units and warehouse space.

This project is an ideal choice for tenants looking for modern office space with the latest technology, unique architecture and an attractive location close to the city centre and the international airport. The space is highly variable and offers the possibility to lease entire floors of 1840 sqm (for Building A) or 490 sqm (for Building B), as well as smaller units. The buildings are designed with energy efficiency in mind and have been certified LEED Platinum. Parking is provided by underground garages with a capacity of 285 parking spaces.

Services: 140,- CZK/m²/month + VAT.

For more information contact the broker.